



Retro-Fit

Non-tiled recessed Niche - White finish

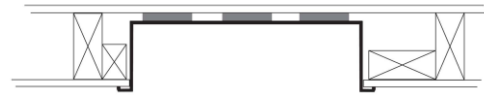

Fig. 1.

STEP 1: Measure and mark wall, recess size is 275mmx375mm. Cut a hole through wall lining/surface (See Figure 2)

STEP 2: Ensure 25mm of wall surface around perimeter of recess is cleaned thoroughly of any residue.

STEP 3: The back of EasyNiche must connect to the rear wall lining for support. Suitable packers (eg. MDF, Plasterboard) may be required to achieve this connection. Face of packers should be a suitable distance from rear of EasyNiche (approx 2-4mm) to allow room for silicone connection. Additional nogging if required to be fitted at this stage. (Fig. 4)

STEP 4: Dry fit EasyNiche into recess and apply blue masking tape to wall lining at 3mm away from perimeter flange of EasyNiche.

STEP 5: Remove EasyNiche and completely fill back side of the flange with a continuous 8mm bead of silicone. Apply silicone to back of EasyNiche as indicated in Fig. 5.

STEP 6: Push EasyNiche firmly into recess and clean off excess silicone from around perimeter. Apply a final silicone seal around exterior EasyNiche flange and wall connection (Fig. 6) Remove blue masking tape.

STEP 7: Secure EasyNiche in place with blue masking tape while allowing a minimum of 24 hours for silicone to cure, before use.

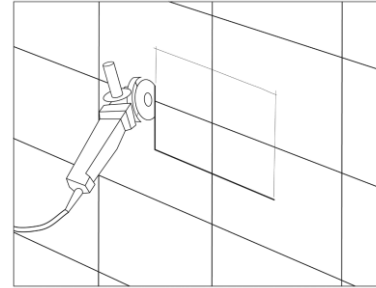

Fig. 2.

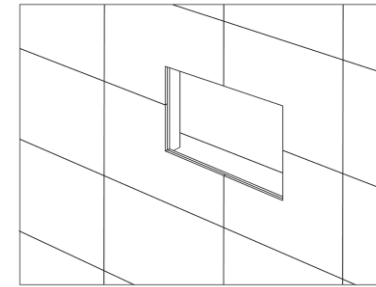

Fig. 3.

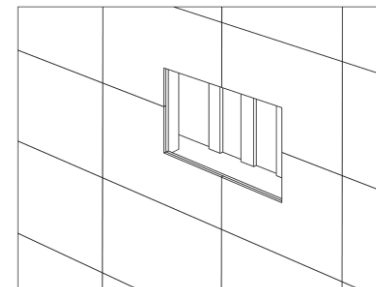

Fig. 4

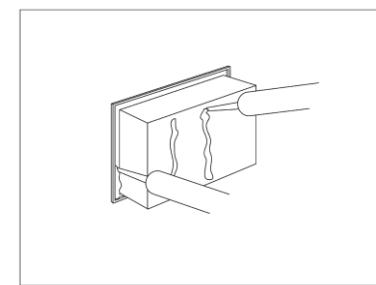

Fig. 5

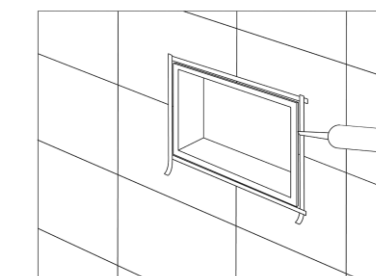

Fig. 6